



# *The Lighthouse Lens*

## ♥ LLTW's Website

LLTW is excited to announce the roll-out of its new website. Content is still being added, but at least we have a place for people to go for more information. It also has the ability to accept donations online! Check it out soon and often.

[WWW.LLTW.ORG](http://WWW.LLTW.ORG)

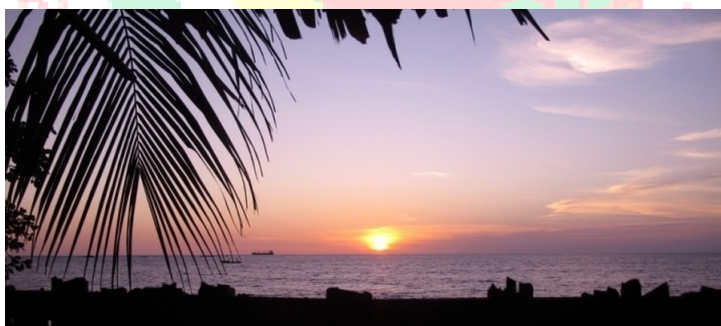

## *In this issue...*

- ⇒ *LLTW's website*
- ⇒ *Calendar of Events*
- ⇒ *Country Update: Ground-breaking Ceremony*
- ⇒ *Building Plans for the Site*
- ⇒ *Calendar Raffle*
- ⇒ *How to contact us*

**On our website, see...**

## **“How You Can Help:”**

1. [Pray](#) for the children and future leaders of Liberia.
2. [Volunteer](#) your services to help LLTW!
3. Make a [Donation](#) today. Hit the donate button to use PayPal or your credit card!

## ♥ Calendar of Events

**Apr. 2, 2012** - Regular Board Mtg.

(6:00pm Ground Round, Pawtucket)

**Apr. 21, 2012** - “Special” Board Mtg.

(7:00pm Providence Church of Christ)

**Apr. 30, 2012** - Regular Board Mtg. for May (6:00pm Ground Round, Pawtucket)

**May, 2012** - Daily drawing winners in Calendar Raffle posted to website.

**Donate**



♥ **Groundbreaking Trip a Huge Success!** From January 2012 thru February 2012 LLTW had two teams of workers in Liberia. Their agenda & accomplishments include:

Prepare for groundbreaking ceremony by visiting the site, begin making contact with local residents and government officials to invite them, attempt to get some sand and cement to be able to make some blocks.

*Team 1 completely exceeded all of our hopes and expectations! They hired a crew, cut a road, built a bridge, hired a dozer contractor, cleared land, purchased tools, built blocks, and start building a warehouse. The teams met with and invited dozens of locals and government officials. As final preparations were being made for the meal, itinerary, and cane pavilion, the teams were hoping for 100 to 150 in attendance. We had 250! The warehouse and security residence have been built, are under roof, and can have concrete flooring poured if additional funds can be sent.*



Make a day trip to CCH, and invite them personally to the groundbreaking. We will offer them financial assistance to cover the costs of the trip.



*CCH was unable to attend the groundbreaking ceremony, but they gladly accepted our invitation to visit them. Team 2 visited CCH on Tuesday and spent several hours talking, eating, encouraging, visiting children, and checking out their progress at the new site in Suakoko. On the way back from this all day trip, we were also able to find a sister orphanage, "Safe Home Children Village", in Flelah and meet with their directors. We were very satisfied that we were able to meet some fellow workers in the cause, and encourage each other, and begin to build a network of contacts that will serve us and the church well into the future. (Pictured to left: Fungbeh & Neyor Karmue, CCH Administrators).*

Visit the University of Liberia Fendell campus, and attempt to setup a "field trip" visit there with some of the kids from CCH. Although we were not able to take children from CCH, we did visit UL Fendell campus. We were impressed with the enormity of this campus. We are blessed that soon UL will transfer all of its undergraduate studies to this campus, which is less than a half hour from our village.

Obtain quotations from local companies to drill a well on the site. We obtained two quotes for drilling the well and installing a pump. Healing Hands International has graciously agreed to fund the well, and completed the transfer of funds a couple of weeks ago. This is a \$5,500 gift from HHI! At the time of this writing, the well is drilled and the pump complete.

Video-tape "interviews" with various people in Liberia for inclusion into our DVD. We took hundreds of digital pictures, and dozens of video segments. All together, it is more than 25 Gigabytes of data! We will have sent this data to Jonathan Burnett who has agreed to edit the material into a DVD for us.

Additional work still collapsed bridge  
pleting paperwork  
LLTW, additional  
fully, if funds per-  
house and con-  
crete blocks



on-going includes: Rebuilding a with local township help, com-  
for official duty-free status for  
clearing of the land, and hope-  
mit, completion of the ware-  
struction of guesthouse con-





♥ This is an artist's rendering of our first major structure to be built ("*Lighthouse Inn*", a missionary guest house). We are hoping to conclude a successful Calendar Raffle fund raiser, which will enable us to pre-build the concrete blocks necessary for the construction of this building. We want to get the blocks made before the rainy season gets in the way (May and beyond). That will give the blocks plenty of time to cure, and will make construction later in the year go

much faster.

We met with an Architect during our time in Liberia, and developed rough draft floor plans of all the buildings planned for this site. To the right is a tentative site plan showing the buildings in their approximate size and location. The green area to the left is sloped land, considered unsuitable for building.

Most of the land has been cleared, but will need some re-shaping and firming up of the borders. It is amazing how fast things can be completed, however, when you have the right people in place. LLTW is blessed to have the right people!

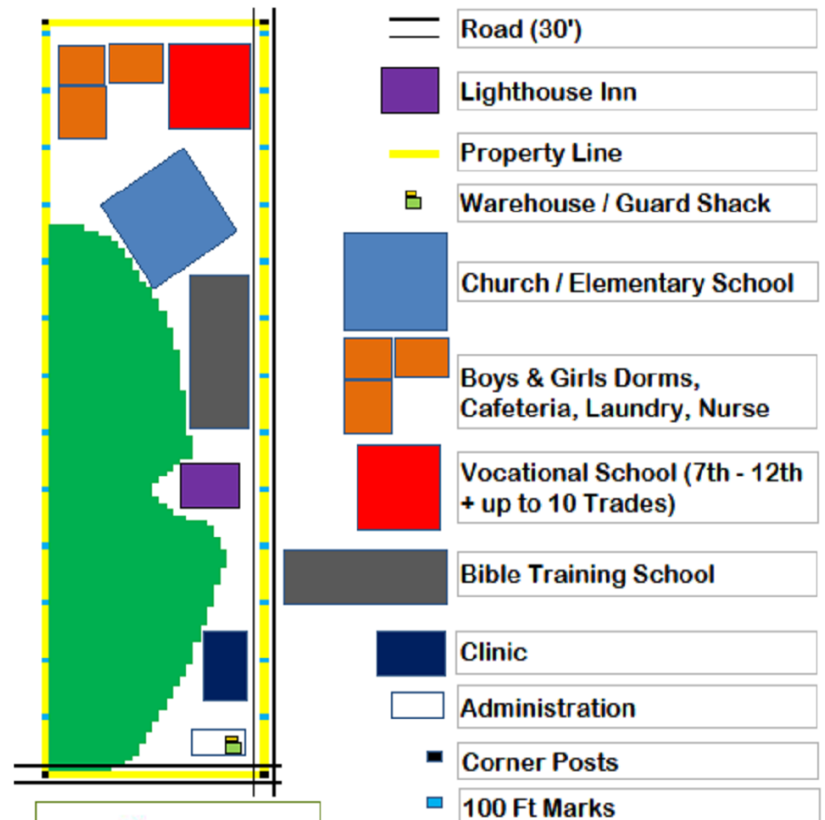

**Love Lights The Way**  
***Fendell Mission in Liberia***  
***"Lighthouse Village"***

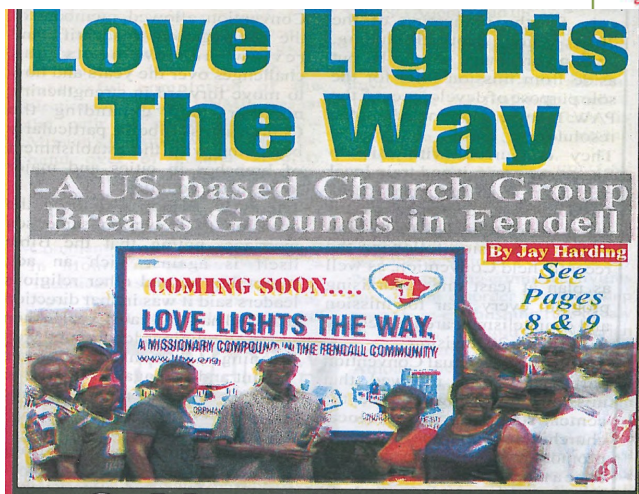

On the left is a picture from the cover of "In Profile", a daily newspaper that covered our ground breaking ceremony. They provided a full center fold spread story in this paper. For a copy of the full article, please send a request to [JWhite@lovelightstheaway.org](mailto:JWhite@lovelightstheaway.org).

## ♥ How to Contact us:

**Facebook** - Search "Love Lights The Way",  
or go to [www.facebook.com/lovelightstheaway](http://www.facebook.com/lovelightstheaway)

**Web** - [www.lltw.org](http://www.lltw.org)

**Mail** - 679 Washington St.  
Ste. #8-334  
S. Attleboro, MA  
02703

**Phone** - (401) 333-8157.

**Email** - [JWhite@lovelightstheaway.org](mailto:JWhite@lovelightstheaway.org)

## ♥ 1st Annual "Calendar Raffle"

Please consider purchasing one or more of our raffle tickets. Each ticket you purchase has 31 chances of being drawn (daily drawings through month of May).

Each daily drawing will pay out from \$100 to \$1,000. If you purchase multiple tickets, and one is drawn, your other tickets are still eligible to be drawn.

We need to sell all 2,500 tickets to make this a successful fund raiser. The proceeds will go to make the concrete blocks for our first large building, the Lighthouse Inn

(missionary guest house). But hurry, April 30th is the last day you can purchase a chance to win.



### LOVE LIGHTS THE WAY FOUNDATION *Calendar Fund Raiser*



**1- 2500**

Donation: \$10

**MAY 2012**

<i>Sunday</i>	<i>Monday</i>	<i>Tuesday</i>	<i>Wednesday</i>	<i>Thursday</i>	<i>Friday</i>	<i>Saturday</i>
		1 \$100	2 \$100	3 \$100	4 \$200	5 \$100
6 \$100	7 \$100	8 \$100	9 \$100	10 \$100	11 \$200	12 \$100
13 \$100	14 \$100	15 \$100	16 \$100	17 \$100	18 \$200	19 \$100
20 \$100	21 \$100	22 \$100	23 \$100	24 \$100	25 \$200	26 \$100
27 \$100	28 \$100	29 \$100	30 \$100	31 \$1,000		

#### Rules

- A \$100.00 Prize will be drawn each day of the week except Friday.
- A \$200.00 Prize will be drawn every Friday.
- The \$1,000.00 Grand Prize will be drawn on May 31st, 2012.
- There are no limitations on the number of times an individual may win.
- LLTW Foundation reserves the right to refund money if insufficient funds are raised.
- The winner's ticket number will be posted on the website daily.  
[www.LLTW.org](http://www.LLTW.org)
- Please make checks payable to LLTW.

(Print Neatly)

Name \_\_\_\_\_ Tel. # \_\_\_\_\_  
Address \_\_\_\_\_ City \_\_\_\_\_ State \_\_\_\_\_  
Email Address \_\_\_\_\_ Sold by \_\_\_\_\_

**1- 2500**